

COOPER SCHOOL

44th Avenue S. and 33rd Street E.

1931

Mrs. Leone Wilder, Principal

| | |
|-------------------------|------|
| Originally Erected | 1923 |
| Number of Class Rooms | 12 |
| Number of Special Rooms | 2 |
| Enrollment | 480 |

COOPER SCHOOL

This school is among the more recent structures of fireproof construction.

DETAILED REPORT

OCCUPANCY: Boilers and fans in basement. Community kitchen, auditorium-gymnasium, office, class rooms and locker room, first. Class rooms and teachers lunch room, second.

CARE AND MAINTENANCE: Building is in good repair and is well maintained.

EGRESS FACILITIES: Fair to good. No panic bars on auditorium exit doors and two short dead end corridors on second floor.

COMMON HAZARDS: LIGHT -- Electric with safely arranged wiring in rigid conduit. HEAT -- Steam from two coal fired low pressure boilers in separate basement room. VENTILATION -- Metal ventilating ducts extend through roof.

SPECIAL HAZARDS: Occasional hand woodworking and painting operations carried on in special class room and activity rooms. Metal cabinet provided for paint stock in special class room. Safely arranged gas ranges in community kitchen and teachers lunch room.

EXPOSURES: None.

FIRST AID PROTECTION: Poor. Insufficient number of chemical extinguishers.

PUBLIC PROTECTION: Full city protection grading third class. Four double head hydrants within 400 feet supplied by six inch mains. Fire department one and one-half miles distant over mostly paved streets. Fire alarm within 75 feet.

RECOMMENDATIONS

1. Chemical extinguisher protection should be made standard.
2. Approved cut off should be provided from boiler room.
3. Metal covered doors should be supplied to opening from corridor, second floor, to roof space over auditorium.
4. Door to roof space over main section should be kept closed at all times.
5. Exit doors from auditorium should be equipped with panic bars.

COOPER SCHOOL

MINNEAPOLIS, MINNESOTA

SCALE: 1 IN. = 50 FT.

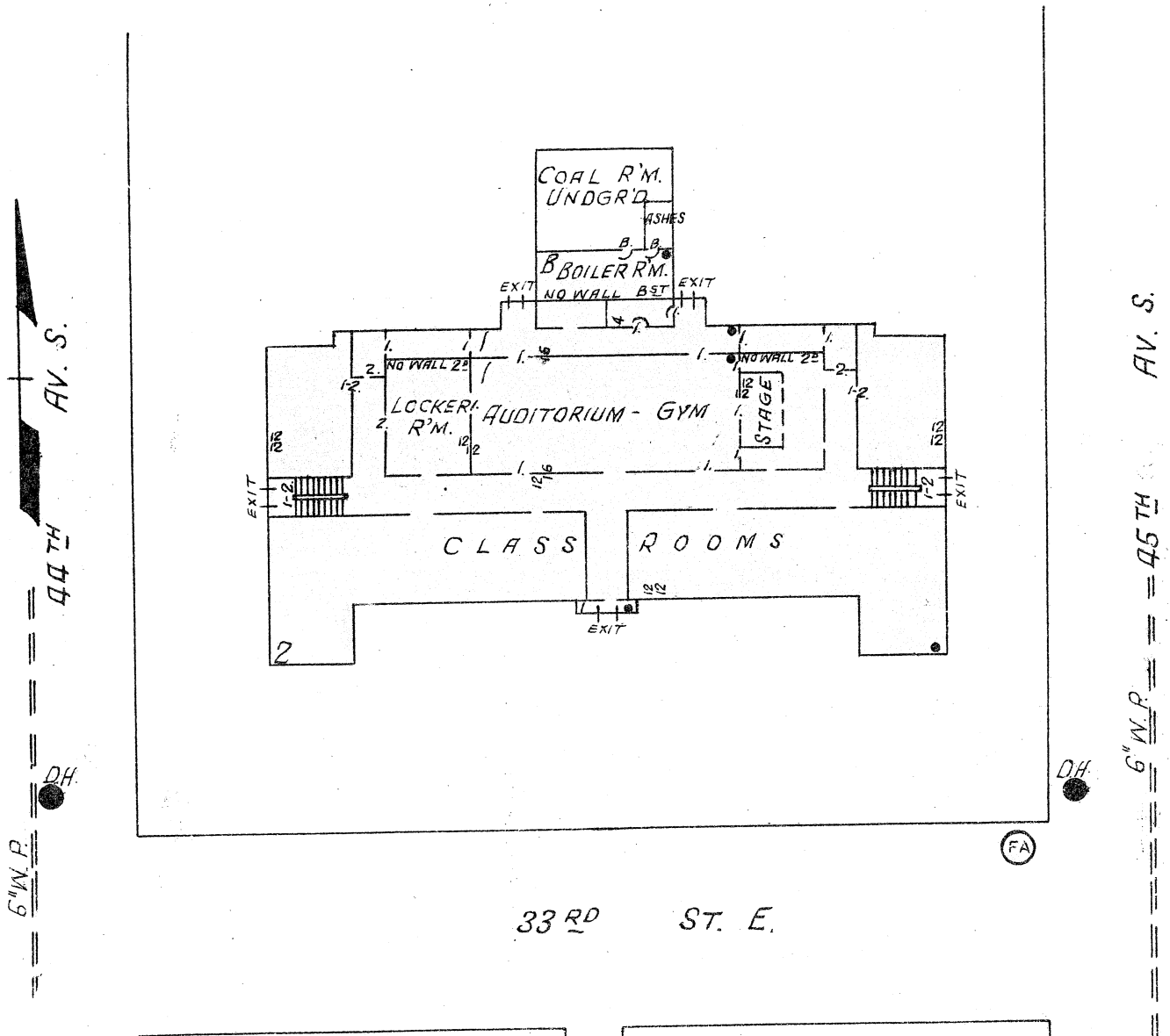

- ERECTED:** 1923.
- CONDITION:** Good.
- HEIGHT:** One and two stories.
- AREA:** Basement, 3000 Sq. Ft., First, 17,250 Sq. Ft., Second, 13,175 Sq. Ft.
- WALLS:** Hollow tile brick faced panels.
- FLOORS:** Reinf. conc. wood surfaced in class rooms.
- ROOF:** False wood over reinf. conc. ceiling, T. and G. surf.
- FLOOR OPENINGS:** One stair to basement in hollow tile encl., metal covered doors. Two open stairs to second.

