

ERICSSON SCHOOL

32nd Avenue S. and 43rd Street E.

1931

Miss Adaline Riedel, Principal

Originally Erected	1916
Number of Class Rooms	16
Number of Special Rooms	0
Enrollment	618

## ERICSSON SCHOOL

This building is of superior construction having brick walls and fireproof floors. Roof ordinary wood joist over suspended metal lath and plaster ceiling. Four frame portable rooms in connection.

### DETAILED REPORT

OCCUPANCY: Boiler room, fan room, gymnasium and storage in basement. Class rooms first and second.

CARE AND MAINTENANCE: Building is in excellent repair and receives good care.

EGRESS FACILITIES: Arrangement of stairways and construction of building afford safe means of egress from all floors.

COMMON HAZARDS: LIGHT -- Electric, wiring in rigid conduit. HEAT Steam from coal fired low pressure steam boiler in fireproof basement room, no standard cut off. VENTILATION -- Metal ventilating ducts extend through roof.

SPECIAL HAZARDS: Gas plate in teachers lunch room, safely arranged.

EXPOSURES: Mutual only, between frame portables.

FIRST AID PROTECTION: Poor protection from chemical extinguishers deficient as to number and type.

PUBLIC PROTECTION: Four well supplied double head hydrants available within 400 feet. Fire department located one-half mile away over unpaved streets. No fire alarm within useful distance.

### RECOMMENDATIONS

1. Chemical extinguisher equipment should be made standard.
2. Opening to boiler room should be supplied with approved three ply automatic fire door.
3. Wood door leading to roof space should be replaced with approved fire door.
4. Exits from auditorium-gymnasium should be properly marked.

# ERICSSON SCHOOL

MINNEAPOLIS, MINNESOTA

SCALE: 1 IN. = 50 FT.

D.H.

43<sup>RD</sup> ST. E.

31<sup>ST</sup> AVE. SO.

32<sup>ND</sup> AVE. SO.

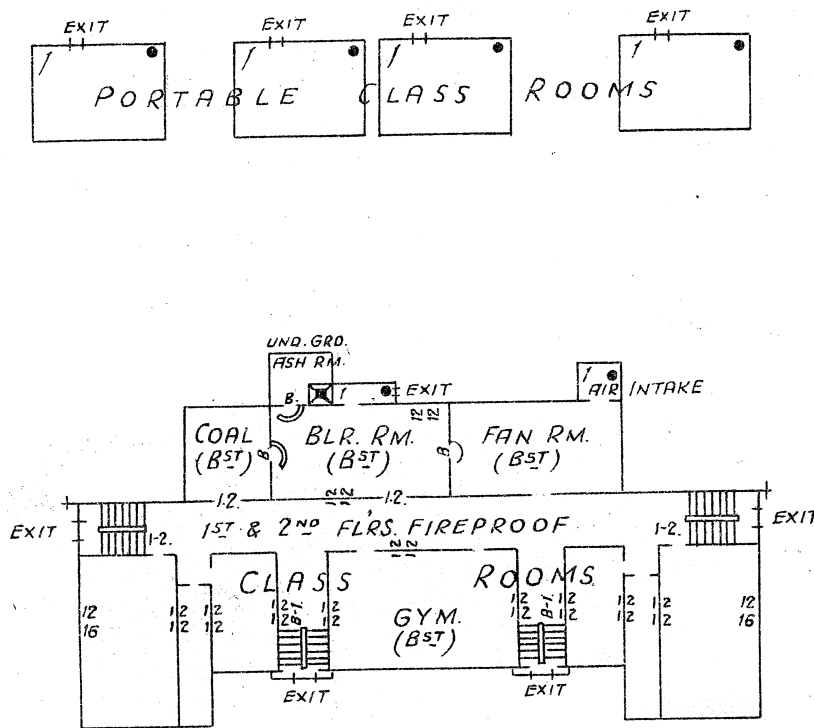

<b>ERECTED</b>	1916.
<b>CONDITION</b>	Excellent.
<b>HEIGHT</b>	Two stories.
<b>AREA</b>	Bsmt., 12,000 sq. ft.; 1st and 2nd, 11,800 sq. ft.
<b>WALLS</b>	Brick, 16 and 12 in.
<b>FLOORS</b>	Reinforced concrete and tile; wood surface in class rooms.
<b>ROOF</b>	Ord. wood joist, tar and gravel surfaced.
<b>FLOOR OPENINGS</b>	Two stairways bsmt. and 1st; two 1st and 2nd.

