

HOWE SCHOOL

43rd Avenue S. and 38th Street E.

1931

Mrs. Claire L. Fredrickson, Principal

Originally Erected	1927
Number of Class Rooms	22
Number of Special Rooms	0
Enrollment	703

HOWE SCHOOL

This building is one of the most recent type of fireproof schools. A frame portable unit has just been added.

DETAILED REPORT

OCCUPANCY: Boiler room, fan room, transformer vault and storage in basement. Auditorium-gymnasium and class rooms, first. Class rooms, second.

CARE AND MAINTENANCE: Excellent. Building practically new.

EGRESS FACILITIES: Good. Stairs from second floor slightly deficient in width but sufficient as to total requirements.

COMMON HAZARDS: LIGHT -- Electric, wiring in safely installed rigid conduit. HEAT -- Steam from two coal fired low pressure boilers in separate basement room with opening protected by approved non-automatic fire door. VENTILATION -- Metal ventilating ducts extend through roof.

SPECIAL HAZARDS: Safely arranged gas range in teachers lunch room. Oil cooled transformers, total 80 K.V.A., in non-standard vault.

EXPOSURES: Mutual only.

FIRST AID PROTECTION: Poor protection afforded by insufficient supply of chemical extinguishers.

PUBLIC PROTECTION: Six inch and eight inch mains supply four double head hydrants within 400 feet. Fire department located three-fourths mile distant over paved and unpaved streets. Fire alarm within 75 feet.

RECOMMENDATIONS

1. Chemical extinguisher equipment should be made standard.
2. Fire door to boiler room should be made automatic.
3. Transformer vault should be made standard.

HOWE SCHOOL

MINNEAPOLIS, MINNESOTA

SCALE: 1 IN. = 50 FT.

43 RD AV. S.

44 TH AV. S.

6" W.P.

6" W.P.

D.H.

D.H.

(F.A.)

38 TH ST. E.

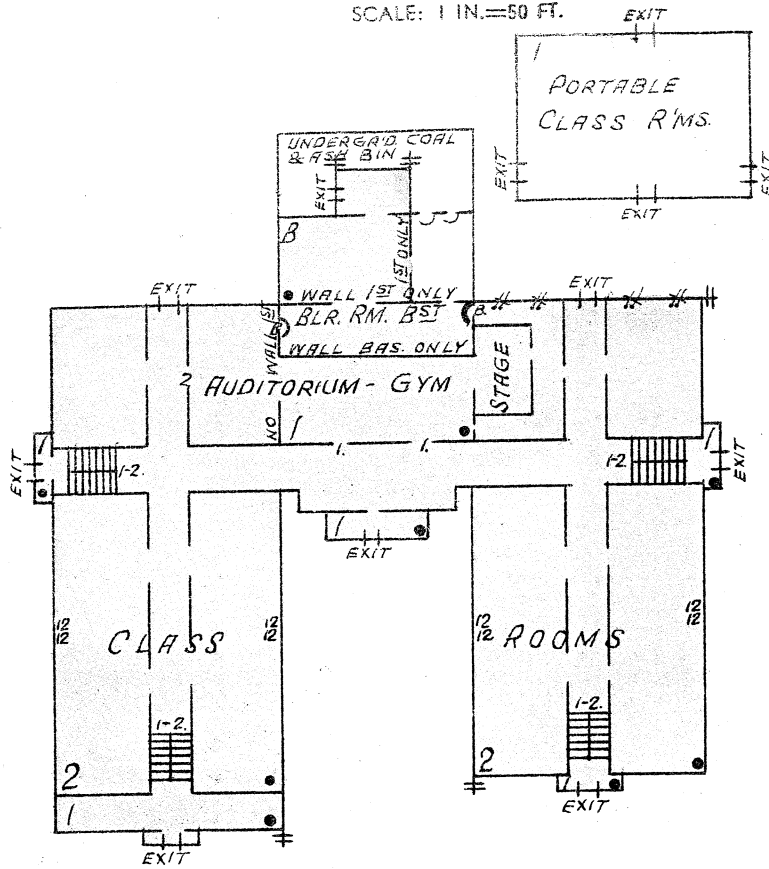

- ERECTED:** 1927.
- CONDITION:** Excellent.
- HEIGHT:** One and two stories.
- AREA:** Basement, 4000 Sq. Ft., First, 18,475 Sq. Ft., Second, 16,125 Sq. Ft., Portable, 2700 Sq. Ft.
- WALLS:** Hollow tile brick faced panels. Portable, frame.
- FLOORS:** Reinf. conc. and tile, wood in portable.
- ROOFS:** False wood over reinf. conc. and tile ceiling, wood joist, portable.
- FLOOR OPENINGS:** 4 open stairs, 1st to 2nd. Enclosed stair bst. to 1st. App. door.

