

MORRIS PARK SCHOOL

38th Avenue S. and 56th Street E.

1931

James F. Lichtenberger, Principal

Originally Erected	1922
Number of Class Rooms	13
Number of Special Rooms	0
Enrollment	502

MORRIS PARK SCHOOL

This school is of ordinary wood joisted brick construction with frame portables in connection.

DETAILED REPORT

OCCUPANCY: Furnace rooms, auditorium and gymnasium and teachers lunch room in basement. Class rooms first floor.

CARE AND MAINTENANCE: This school has not been given the usual good care inasmuch as it has been planned to provide a new school for this district.

EGRESS FACILITIES: Fair to good. Rear exit doors, main building, not supplied with panic bars.

COMMON HAZARDS: LIGHT -- Electric, wiring in conduit and in open, installation fair to poor. HEAT -- Hot air. Two furnace rooms, one new part and one old part, connected by fireproof tunnel. Furnaces, in new section, in fireproof room not cut off. Wood lath and plaster ceiled, ordinary joist floor over furnaces in old section. VENTILATION -- Ventilating ducts extend through roof.

SPECIAL HAZARDS: City gas range in teachers lunch room, safely arranged. No manual training.

EXPOSURES: Dwelling properties only.

FIRST AID PROTECTION: Poor inside protection from deficient supply of chemical extinguishers and non-approved system of standpipe and hose.

PUBLIC PROTECTION: Four double head hydrants on 6 inch and 8 inch mains available within 400 feet. Fire department one and one-half miles distant over paved and unpaved roads. Protection at risk grades fifth class.

RECOMMENDATIONS

1. Chemical extinguisher equipment should be made standard.
2. Standpipe equipment should be made standard.
3. Electrical installation should be made to conform with National Code.
4. Wood floor over old furnace room should be replaced with fireproof floor and all openings to room protected with approved fire doors.
5. Opening to new furnace room should be protected with approved fire doors.
6. Stairway should be provided from old furnace room to outside.
7. Wood door to ash bin should be replaced with metal door.

MORRIS PARK SCHOOL

MINNEAPOLIS, MINNESOTA

SCALE: 1 IN. = 50 FT.

38TH AVE. SO.

39TH AVE. SO.

8" W.P.

6" W.P.

300' TO HYD.

D.H.

D.H.

56TH ST. E.

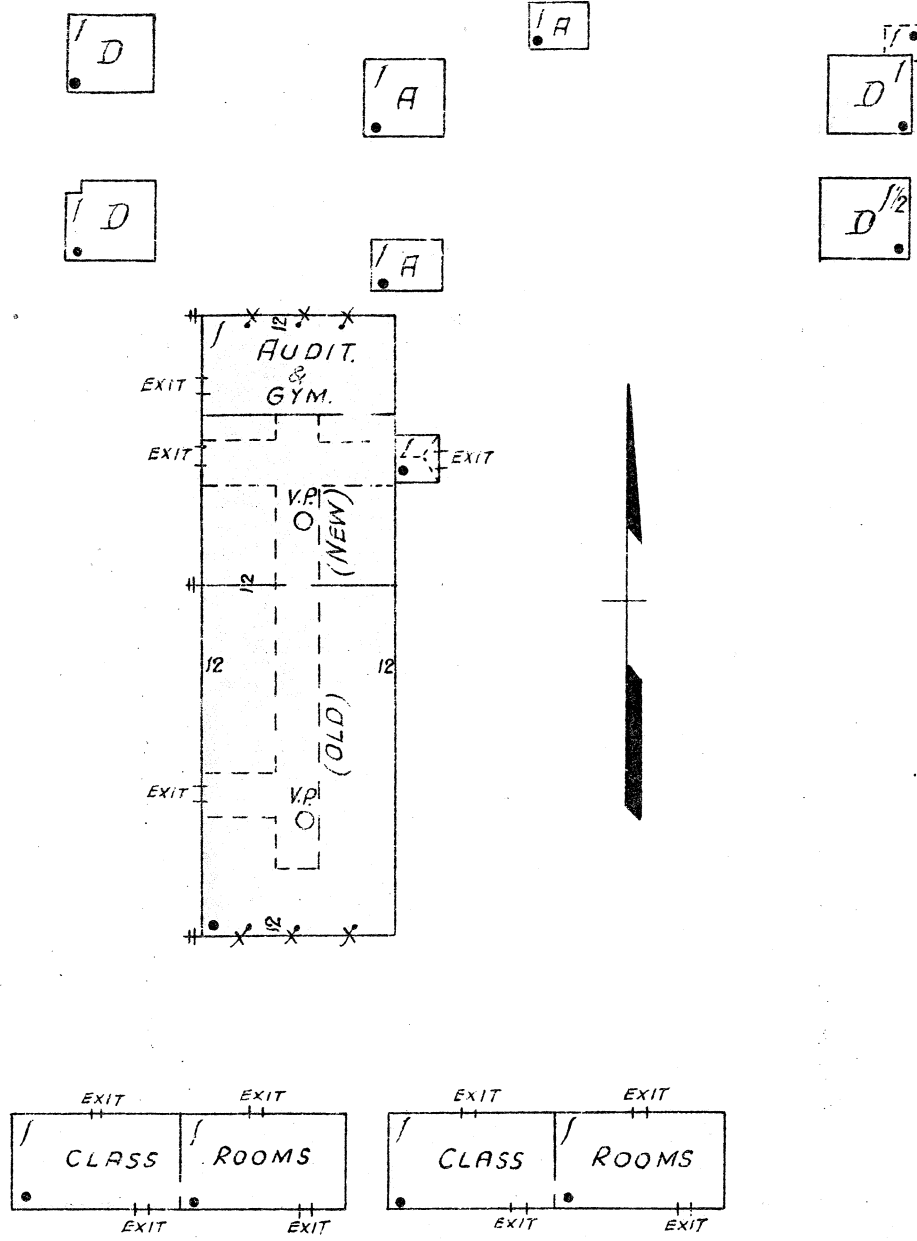

- ERECTED** 1922, Add'n. 1923.
- CONDITION** Fair to good.
- HEIGHT** One story.
- AREA** Main section, basement 3,000 Sq. Ft.
First, 8,000 Sq. Ft. Portables 2,200 Sq. Ft. each.
- WALLS** 8" hollow tile, 4" brick faced. Portables frame.
- FLOORS** Tile and reinforced concrete over new boiler room, balance wood.
- ROOF** Ordinary wood joist.
- FLOOR OPENINGS** One open stair to basement.

