

NORTHROP SCHOOL

E. 46th Street and 16 Avenue S.

1931

Elizabeth J. Kaasa, Principal

Originally Erected	1923
Number of Class Rooms	12
Number of Special Rooms	0
Enrollment	488

NORTHROP SCHOOL

The brick section is of fireproof construction, the annex frame and sections communicate with each other through one unprotected opening. Eventually the annex will be removed to make way for fireproof additions forming a typical grade school.

DETAILED REPORT

OCCUPANCY: This building contains no special features.

CARE AND MAINTENANCE: Building in good repair and well maintained.

EGRESS FACILITIES: Poor from second floor of main building, there being only one open stairway to the first floor. An open wood fire escape is located between the two sections, of no value on account of open wood construction and heavily exposed by frame annex. This condition is very unsafe and should be remedied immediately. Outer doors in main building equipped with panic bars. Rooms in annex have direct exits from each room to outside in addition to openings into center corridor. Vestibule doors in annex not free swinging. All outer doors free swinging except one where panic bar should be installed.

COMMON HAZARDS: LIGHT -- Electric lights with wiring in metal conduit. HEAT -- Steam in main building, boiler located in basement of fireproof addition communicating into corridor through openings protected by non-standard fire doors. Hot water in annex, plant located in frame, metal lined addition. VENTILATION -- Metal ventilating flues are carried through roof.

SPECIAL HAZARDS: COOKING -- Gas plate in teachers lunch room, safe.

PAINTING -- Small amount of brush work in annex, paints stored in wood cabinet.

EXPOSURES: None.

FIRST AID PROTECTION: Inadequate supply of chemical extinguishers there being two extinguishers in the annex and one on the first and one on the second floor in the main building. Electric alarm in main building.

PUBLIC PROTECTION: Adequate number of hydrants nearby, station seven blocks from school over part paved streets; fire alarm box 375 feet.

RECOMMENDATIONS

1. Install approved three ply fire doors on openings between boiler room and corridor.
2. Install approved three ply trap door on opening into attic space.
3. Install sufficient chemical fire extinguishers.
4. Provide metal cabinet for all paints.
5. Remove present wood fire escape, replacing same with smoke proof tower or ramp, located at south end of building.
6. Make vestibule doors in annex free swinging.
7. Install panic bar on outer door in annex.

NORTHROP SCHOOL

MINNEAPOLIS, MINNESOTA

SCALE: 1 IN. = 50 FT.

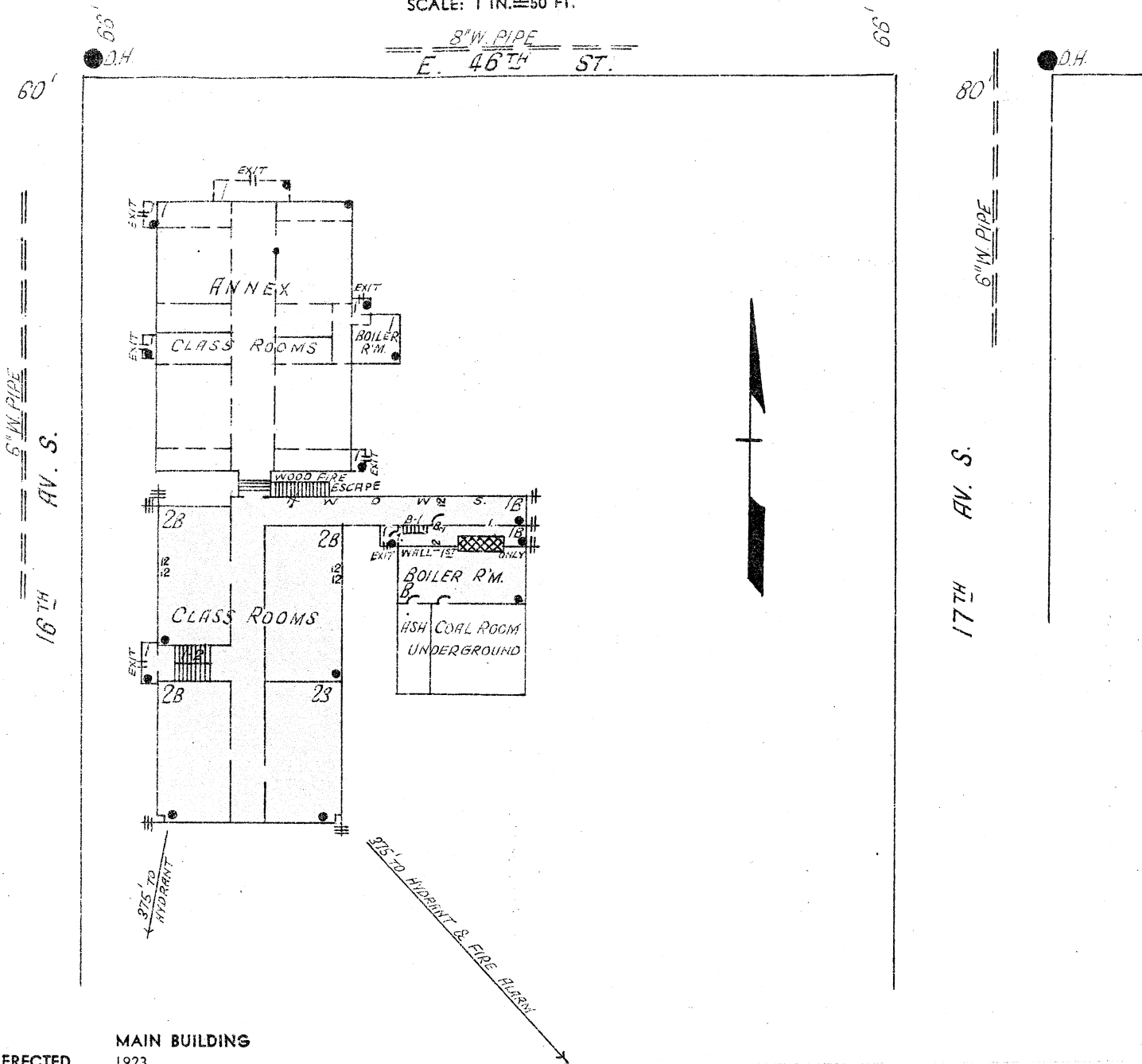

ERECTED
CONDITION
HEIGHT
AREA
WALLS
FLOORS
ROOF
FLOOR
OPENINGS
CONDITION
HEIGHT
AREA
WALLS
FLOOR
ROOF

MAIN BUILDING

1923.
Good.
One and two stories.
Basement, 1,470 Sq. Ft., first, 7,850 Sq. Ft., second, 6,000 Sq. Ft.
8" hollow tile faced with 4" brick.
Reinforced concrete.
Ordinary wood, composition surfaced concrete ceiling under.
One enclosed stairway, basement to first and one open stairway, first to second.

ANNEX

Fair.
One story.
5,390 Sq. Ft.
Ordinary wood.

