

WENONAH SCHOOL

28th Avenue S. and 60th Street E.

1931

James F. Lichtenberger, Principal

Originally Erected	1924
Number of Class Rooms	6
Number of Special Rooms	0
Enrollment	170

WENONAH SCHOOL

This school is of ordinary wood joisted brick construction with frame portable in connection.

DETAILED REPORT

OCCUPANCY: Furnace room, fan room and storage in basement. Auditorium and class rooms, first. Class rooms, second.

CARE AND MAINTENANCE: Good.

EGRESS FACILITIES: Poor exit facilities on account of single stair from second. All doors provided with panic bars where necessary.

COMMON HAZARDS: LIGHT -- Electric, wiring in conduit well installed.

HEAT -- Hot air, furnace in fireproof basement room, safely arranged. VENTILATION -- Metal ventilating ducts extend through roof.

SPECIAL HAZARDS: Electric range used for coffee making, safely installed. No manual training.

EXPOSURES: None.

FIRST AID PROTECTION: Fair protection afforded by slightly insufficient number of chemical extinguishers. Standpipe, first and second floors of main section, with 50 feet of hose attached. Water supply from 1500 gallon pressure tank in basement. Standpipe protection fair.

PUBLIC PROTECTION: No protection other than city chemical equipment located in fire department $2\frac{1}{2}$ miles distant over paved and unpaved streets.

RECOMMENDATIONS

1. Chemical extinguisher protection should be made standard.
2. Door to basement stairway should be made self-closing.
3. Approved fire door should be provided for opening to furnace room.
4. Provide safe means of exit from second floor, either smoke-proof tower or ramp.

WENONAH SCHOOL

MINNEAPOLIS, MINNESOTA

SCALE: 1 IN. = 50 FT.

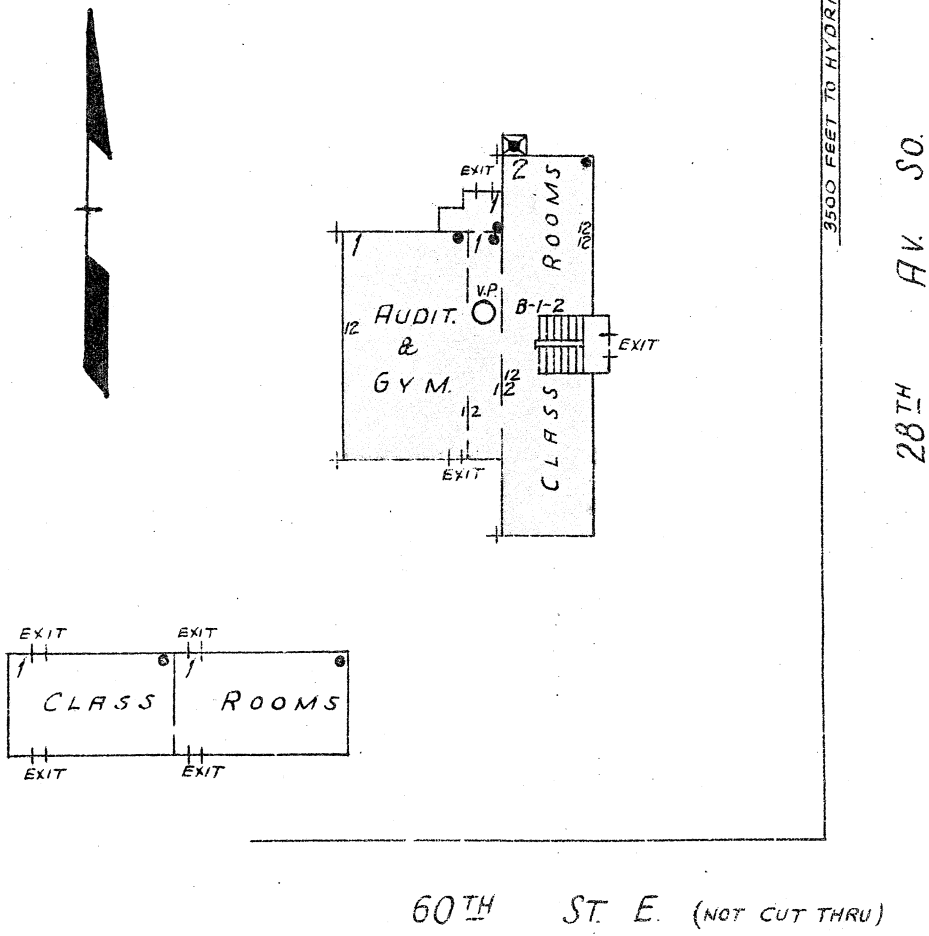

- ERECTED** 1924
- CONDITION** Good
- HEIGHT** One and two stories
- AREA** Main section, basement, 1,200 Sq. Ft.
first, 5,000 Sq. Ft., second 2,500 Sq Ft.
Portable, 2,550 Sq. Ft.
- WALLS** Main section, 8" Hollow tile, 4" brick faced. Portable, frame
- FLOORS** main section, reinforced concrete and tile boilerroom section, ordinary wood joist else-where
- ROOFS** Ordinary wood joist, composition, tar and gravel surfaced
- FLOOR OPENINGS** Stairway, basement to first in hollow tile enclosure, with M. C. door at basement level. Stairway first to second open

